

Yaskawa Motion Classes

Located in Waukegan, IL (about 40 miles north of Chicago, IL)

State-of-the-art Dedicated Training Facility covering 5,400 sq. ft.

Great way to learn about servo and motion capabilities and latest trends

Products Covered

The products we train on include, but are not limited to, the following:

- Sigma-5
- Sigma II
- MotionWorks IEC
- MotionWorks v6
- MotionWorks+
- MP2300Siec

Classes Offered

We offer training classes at all levels of interest. These include, but are not limited to:

- Application Programming
- Tuning
- Hands-on Application Programming
- eLearning Curriculum

Class Material

At our training classes, we provide you with the tools to learn:

- Course Workbook
- Product Documentation
- Notepad
- Pen, Pencil, & Highlighter

Class Size

In order to allow more one-to-one training, we have class size limits:

- HQ Classes limited to 8 (max)

Equipment Provided

No need to bring anything along but a willingness to learn.

We provide:

- PCs
- Product Demo
- Application Demo
- Hand Tools
- Electrical Wire
- Digital Multi-meter
- Oscilloscope
- 3-phase Power

Schedule

We maintain a comprehensive training schedule on our website, sorted by product and/or date:

- Visit: <http://motiontraining.yaskawa.com>

For courses not shown on the existing schedule, contact Training.

Who Do We Train?

- Programmers
- Technicians
- Engineers
- Mechanics
- Maintenance Workers
- Electricians
- Sales staff

Contact

To register or find out more about our course offerings:

- E-mail: training@yaskawa.com
- Phone: 1-800-YASKAWA (927-5292)

To learn more about what we have to offer in Technical Training Services, please visit www.Yaskawa.com

There you'll find the following useful information:

- Motion class schedule
- Description of what's covered in each class
- Start / End times and dates of scheduled classes
- Tuition fees
- Maps / Directions to the office from area airports
- Hotel and area information
- eLearning Modules (some include certification tests)

You can also find a Course Selection Tool to help you determine which class(es) are best for you!

Our classrooms are state-of-the-art and are designed as training rooms from the ground up – not modified conference rooms. We have lecture and hands-on training labs for classroom study. Our floor plan encompasses two (2) Training Rooms seating up to 12 students in each and two (2) Training Lecture Halls holding 18 students each. These rooms have desktop computers with flat screen monitors at each workstation.

We also have two (2) Training Labs for 12 students each. These rooms are equipped with 230v and 460v (3 phase) power, as well as tool chests at each workstation.

Training Facility Floorplan

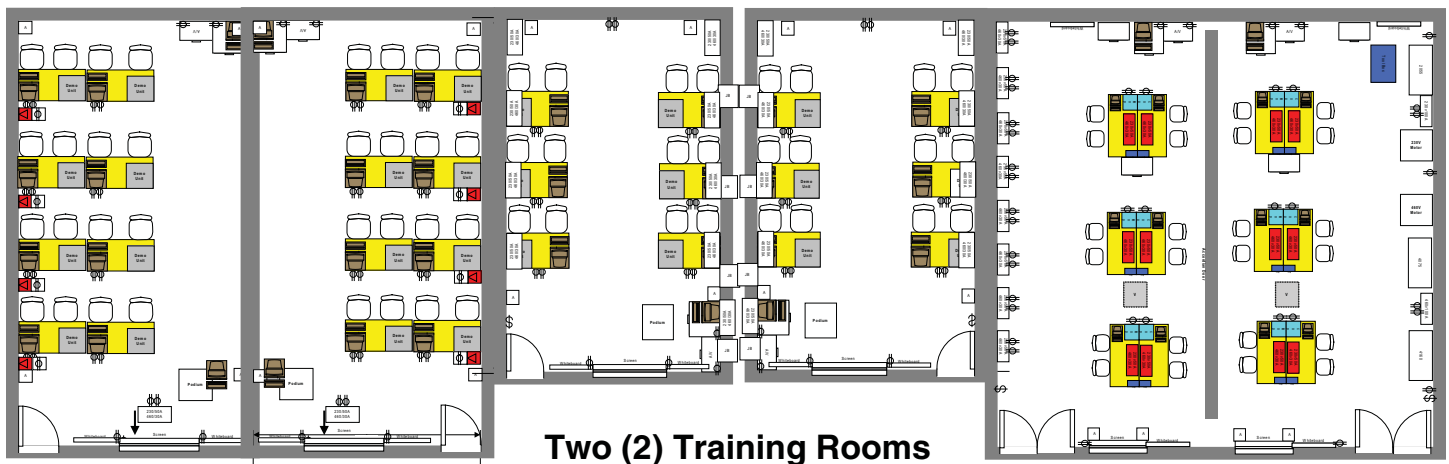

Two (2) Lecture Halls

Two (2) Training Rooms

Two (2) Training Labs



Yaskawa Electric America, Inc.
2121 Norman Drive South
Waukegan, IL 60085
800-YASKAWA (927-5292) Fax: 847-887-7310
www.yaskawa.com

Yaskawa Motion Classes