

- NOTES:
- MUST USE TYPE 3R RATED HUBS OR FITTINGS (OR EQUIVALENT) TO MAINTAIN ENCLOSURE RATING
 - FANS, FILTERS OR CLOSING PLATES ARE SUPPLIED WHEN OPTION MIX NECESSITATES
 - DIMENSIONS ARE IN INCHES AND [MM]
 - SUPPLIED WHEN FLANGE MOUNTED CB/DISCONNECT IS SPECIFIED

PROJECT NAME	
SYSTEM TAG#	
MODEL#	
HP	
AMPS	
VOLTS	
WEIGHT	

YASKAWA

THIS DOCUMENT AND INFORMATION CONTAINED HEREIN IS CONFIDENTIAL AND NOT TO BE COPIED OR DISCLOSED IN WHOLE OR IN PART WITHOUT THE EXPRESS WRITTEN CONSENT OF YASKAWA ELECTRIC AMERICA INC.

DRAWN: JJS	DATE: 10/30/09	TITLE: OUTLINE DRAWING TYPE 3R WALL MOUNT 40HX32WX16D
CHECKED: JZ	DATE: 10/30/09	
TECH: D	DATE: 10/30/09	
APPROVED: JZ	DATE: 10/30/09	
ORIGINAL DESIGN: MKK	DATE: 3/5/07	

SIZE: D	REVISION: R01	PAGE: 1 OF 2
DRAWING #: DD.AFD.199.01		

12.0" HIGH LEGS

LEG STAND MOUNTING OPTION DIMENSIONS

30.0" HIGH LEGS

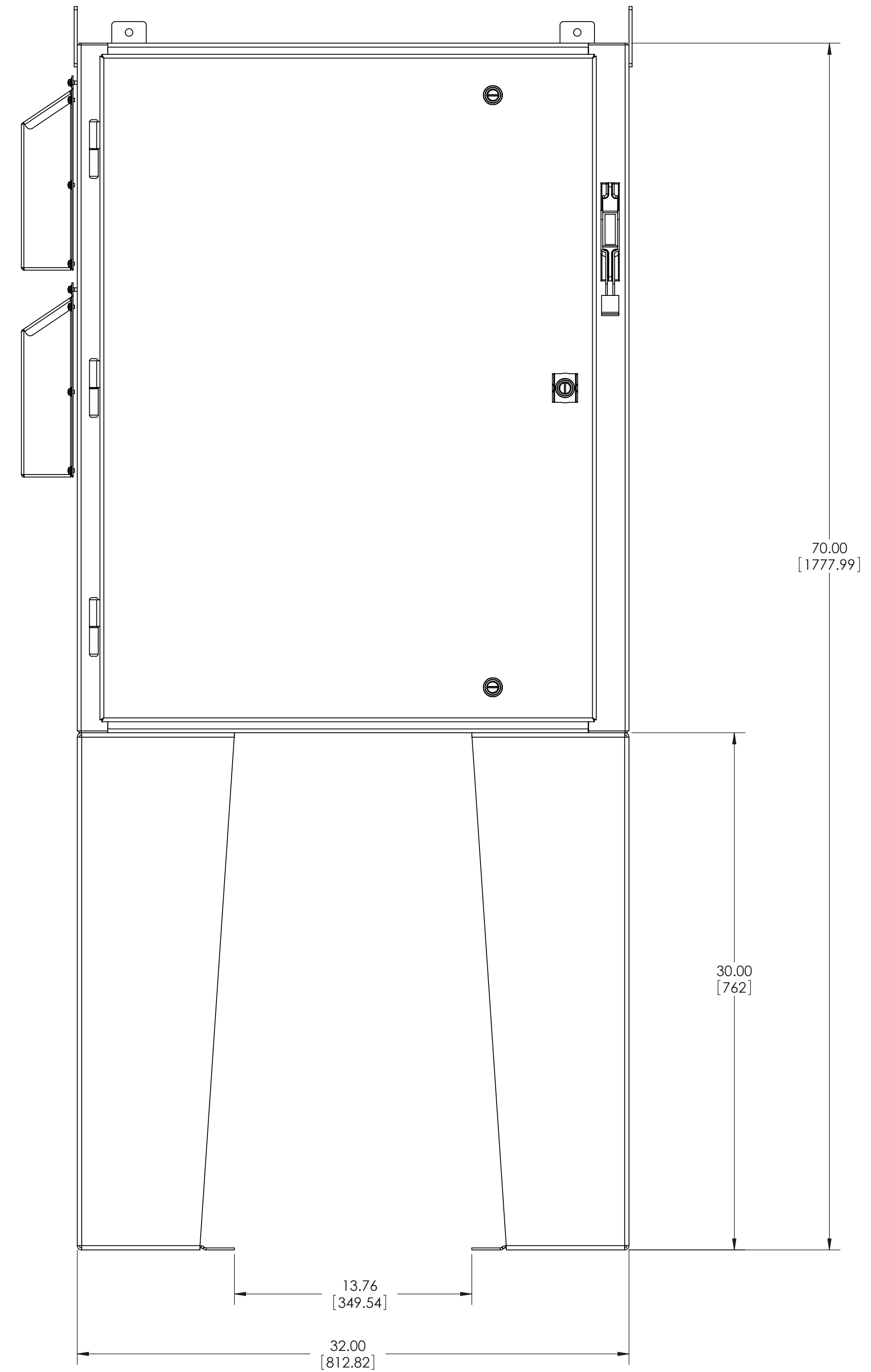
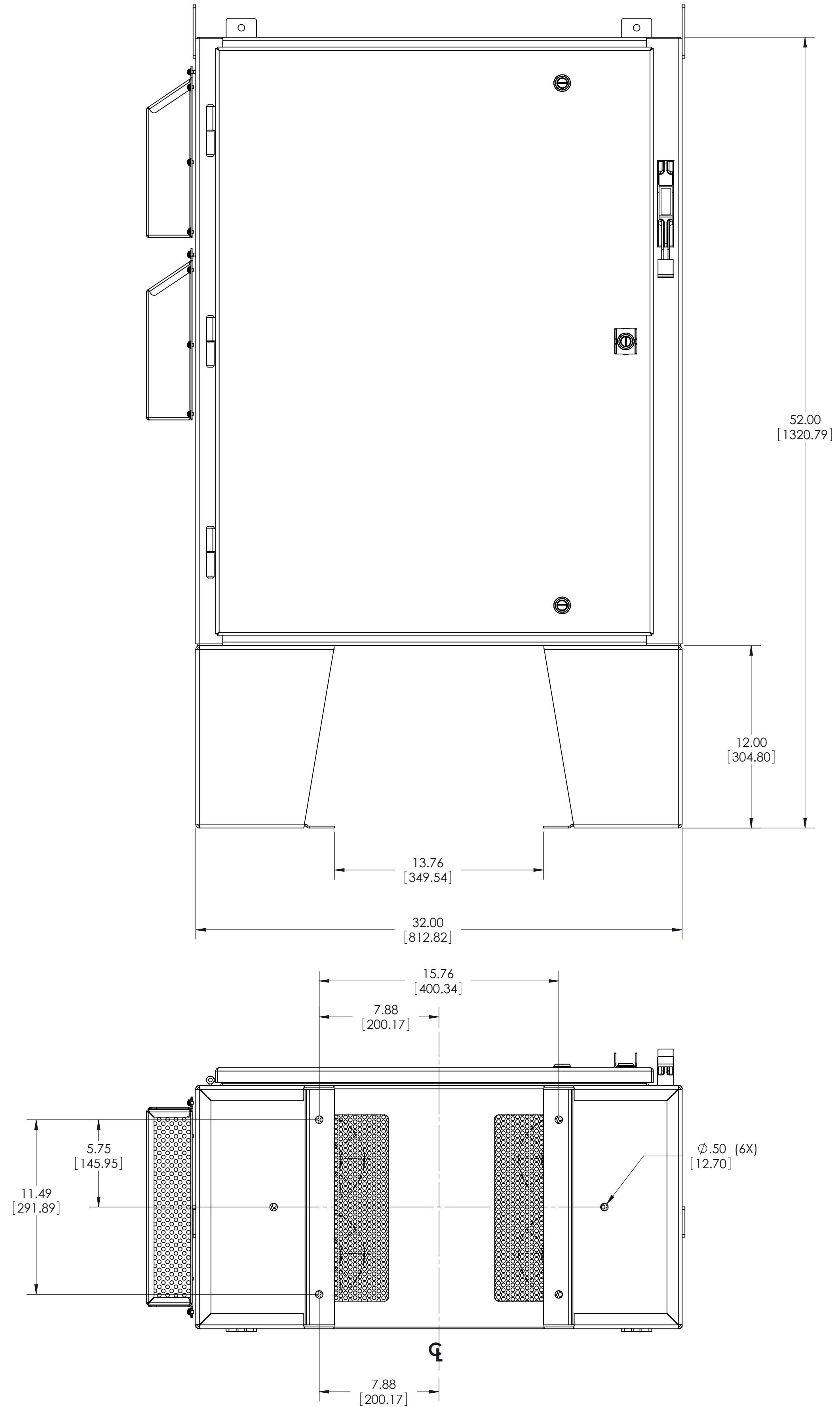

	DRAWN: JJS	DATE: 10/30/09	TITLE: OUTLINE DRAWING	
	CHECKED: JZ	DATE: 10/30/09	TYPE 3R WALL MOUNT	
	TECH: D	DATE: 10/30/09	MATERIAL#	-
	APPROVED: JZ	DATE: 10/30/09	SIZE	D
ORIGINAL DESIGN: MKK	DATE: 3/5/07	REVISION	R01	PAGE 2 OF 2
<small>THIS DOCUMENT AND INFORMATION CONTAINED IN IT ARE CONFIDENTIAL, AND CANNOT BE COPIED OR DISCLOSED IN WHOLE OR IN PART WITHOUT THE EXPRESS WRITTEN CONSENT OF YASKAWA ELECTRIC AMERICA INC.</small>			DRAWING #: DD.AFD.199.01	