

**Detail A**  
**Top mounting hole dimensions**  
**Scale 1:1**

The dimensions shown are for an IP20 Type Drive that has been converted to a U/L Type 1 Drive by adding the parts from U/L Type 1 Kit part number 900-192-121-009

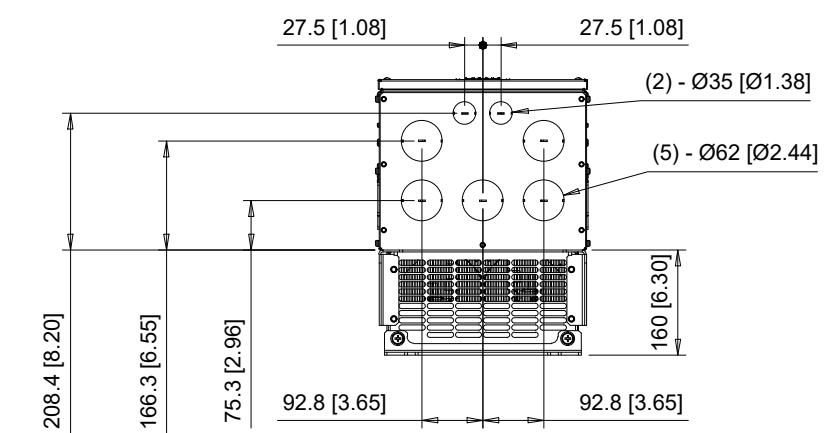

C/C: FP65□	INPUT VOLTAGE 3-PHASE (VAC)	WEIGHT Kg (lb)	COOLING FANS
2211□□□	200 TO 240	70 (154.3)	2
2273□□□		73 (160.9)	2
4180□□□	380 TO 480	72 (158.7)	2
4240□□□		74 (163.1)	2
4302□□□		77 (169.8)	2

□ denotes A-Z



UNITS MM [IN]  
 SCALE 1:12

DRWN.	J. MATTAS	3-31-22
CHKD.	J. PIOTROWSKI	4-20-22
TECH.	L. UDDIN	4-23-22
APRV.	J. CAIRO	4-21-22

TITLE  
 FP605 DIMENSION DRAWING  
 FRAME SIZE 9  
 IP20/UL TYPE 1 ENCLOSURE

SIZE A  
 PAGE 1 OF 3  
 DWG.NO.  
 DD.FP605.FR9.T1

REV  
 0

A B C D E F G H I J

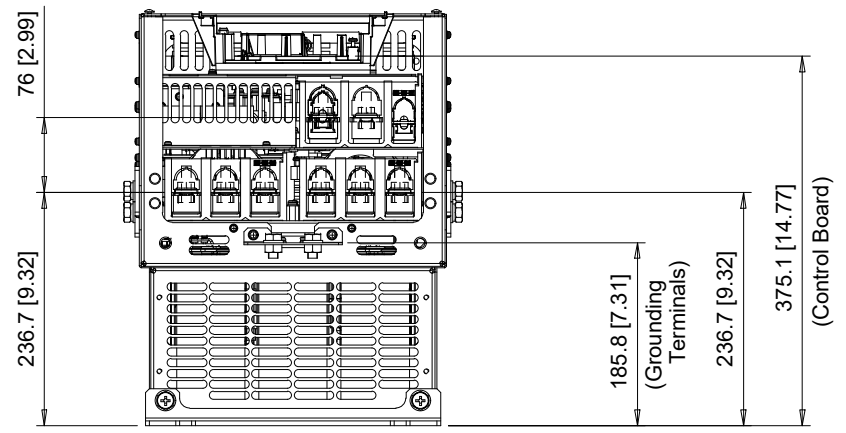
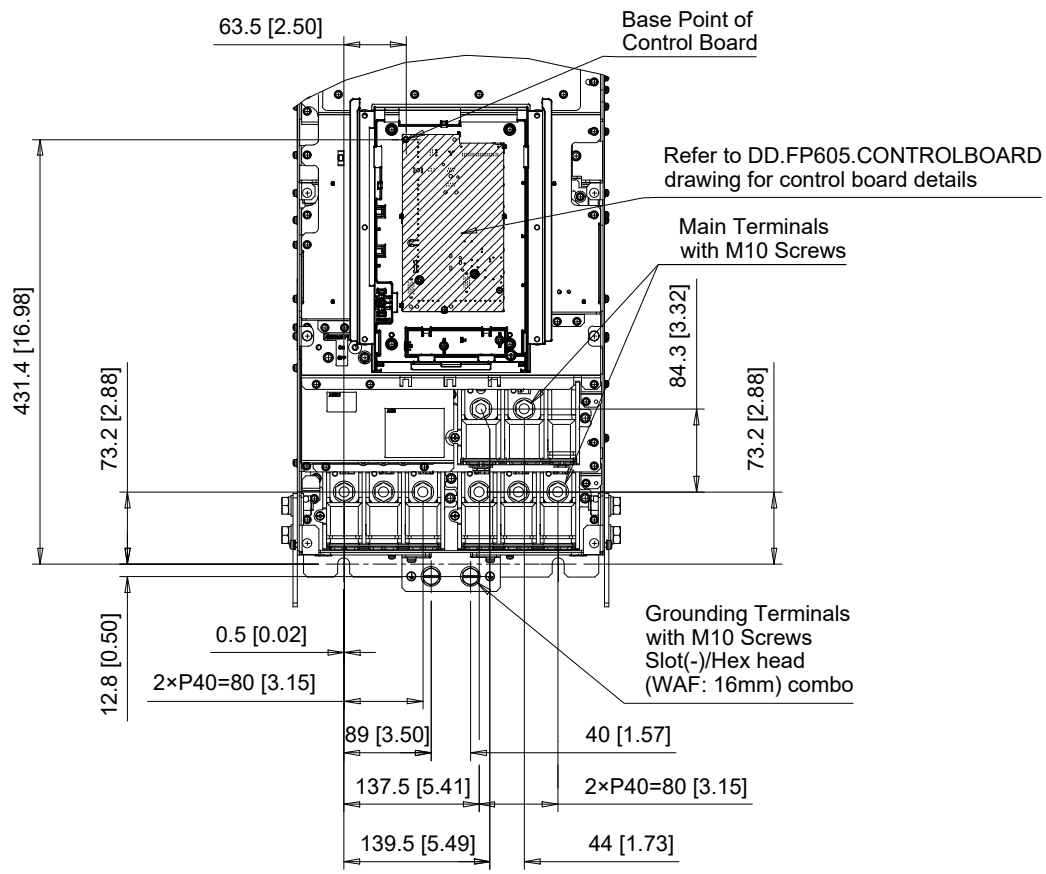

C/C:	TERMINAL SYMBOL	WIRE RANGE AWG (mm <sup>2</sup> )	TERMINAL SCREW	CLAMPING TORQUE N.m. (lb.in.)
FP65□	R/L1, S/L2, T/L3	3 - 4/0 x 2P (30 - 120 x 2P)	M10	20 (177)
2273□□□	U/T1, V/T2, W/T3	3 - 4/0 x 2P (30 - 120 x 2P)	M10	20 (177)
4180□□□	-, +1	2 - 250 x 2P (35 - 120 x 2P)	M10	20 (177)
4240□□□	⊕	2 - 350 (35 - 185)	M10	18 - 23 (159 - 204)
4302□□□				

□ Denotes A-Z  
 Note: Refer to applicable codes and standards for proper wire type and size.

**YASKAWA**

UNITS MM [IN]  
 SCALE 1:8

DRWN. J. MATTAS 3-31-22  
 CHKD. J. PIOTROWSKI 4-20-22  
 TECH. L. UDDIN 4-23-22  
 APRV. J. CAIRO 4-21-22

TITLE  
 FP605 DIMENSION DRAWING  
 FRAME SIZE 9  
 IP20/UL TYPE 1 ENCLOSURE

SIZE A PAGE 2 OF 3  
 DWG.NO. DD.FP605.FR9.T1

REV 0

Minimum Installation Clearances (Scale 1:10)

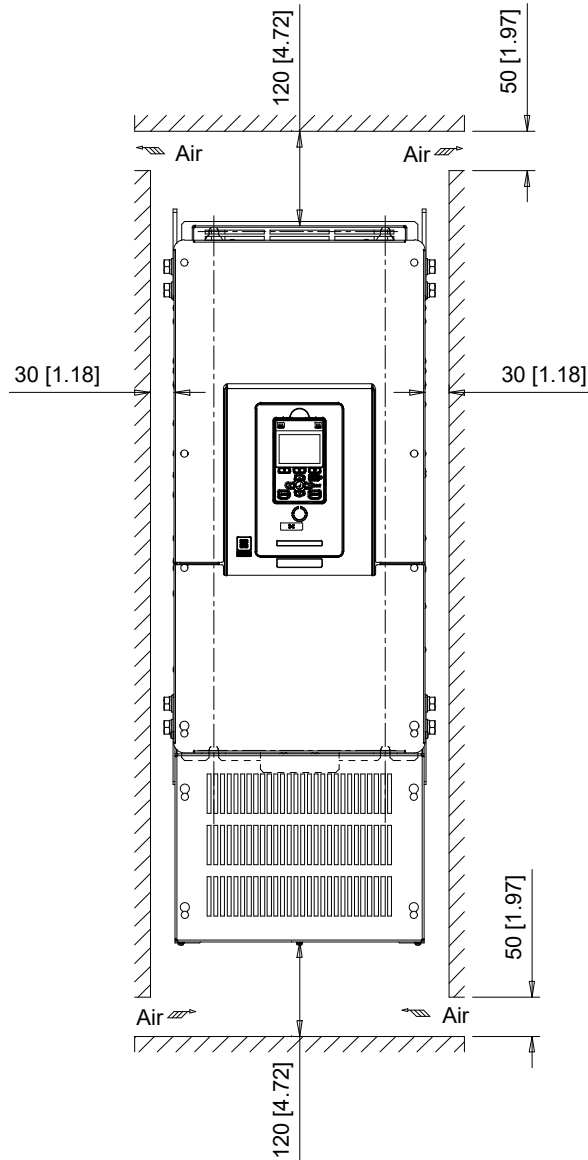

Note:  
For alternate mounting configurations, consult manual.

**YASKAWA**

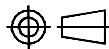

UNITS MM [IN]  
SCALE ABOVE

DRWN.	J. MATTAS	3-31-22
CHKD.	J. PIOTROWSKI	4-20-22
TECH.	L. UDDIN	4-23-22
APRV.	J. CAIRO	4-21-22

TITLE  
FP605 DIMENSION DRAWING  
FRAME SIZE 9  
IP20/UL TYPE 1 ENCLOSURE

SIZE A PAGE 3 OF 3  
DWG.NO.  
DD.FP605.FR9.T1

REV  
0