

(4) Mounting Holes for M5 [#10] Screws.

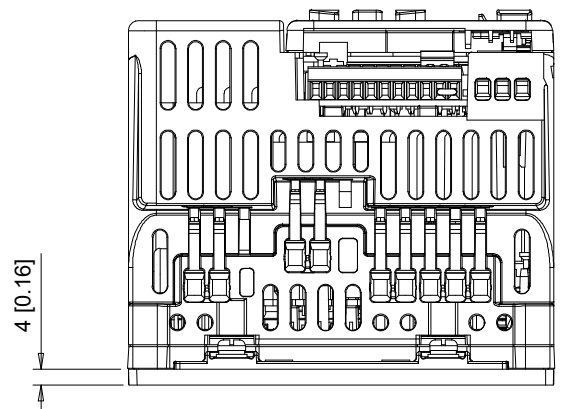
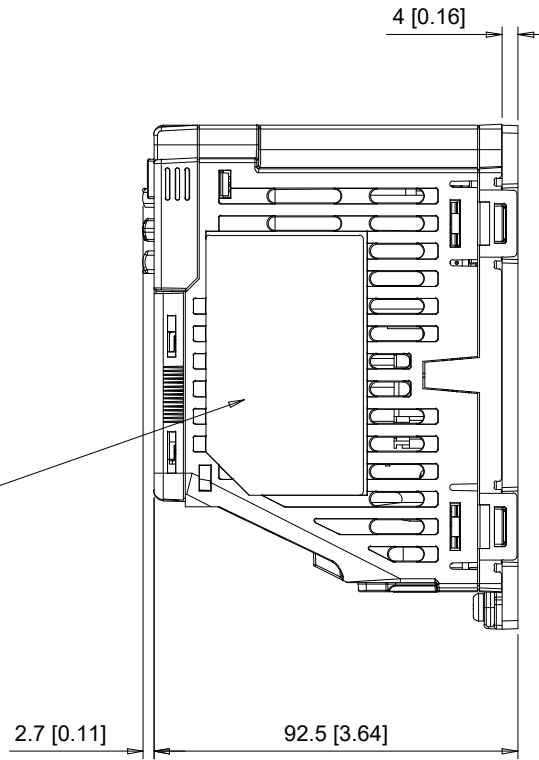

C/C:	INPUT VOLTAGE (VAC)	WEIGHT Kg (lb)
GA50□		
B010□□□	200 TO 240 1-PHASE	1.0 (2.2)

□ denotes A-Z

YASKAWA

UNITS MM [IN]
SCALE 1:2

DRWN. J. MATTAS 7-20-21
CHKD. J. PIOTROWSKI 7-21-21
TECH. L. UDDIN 8-10-21
APRV. J. CAIRO 8-17-21

TITLE
GA500 DIMENSION DRAWING
FRAME SIZE 2.5
FINLESS HEATSINK

SIZE A PAGE 1 OF 3
DWG.NO. DD.GA50.FR2.5.FNL

REV 0

FRONT VIEW

BOTTOM VIEW

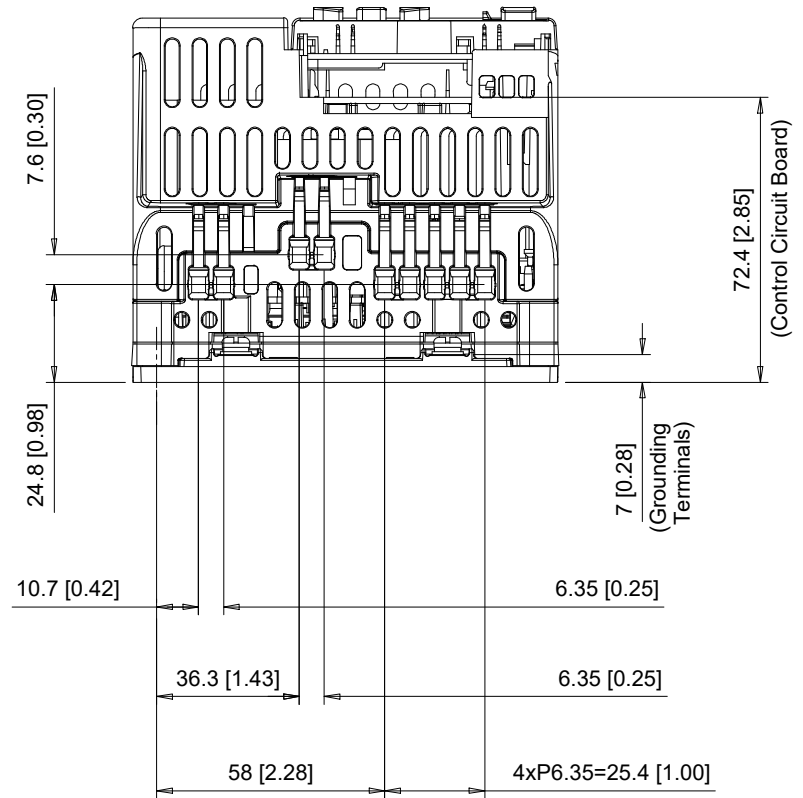
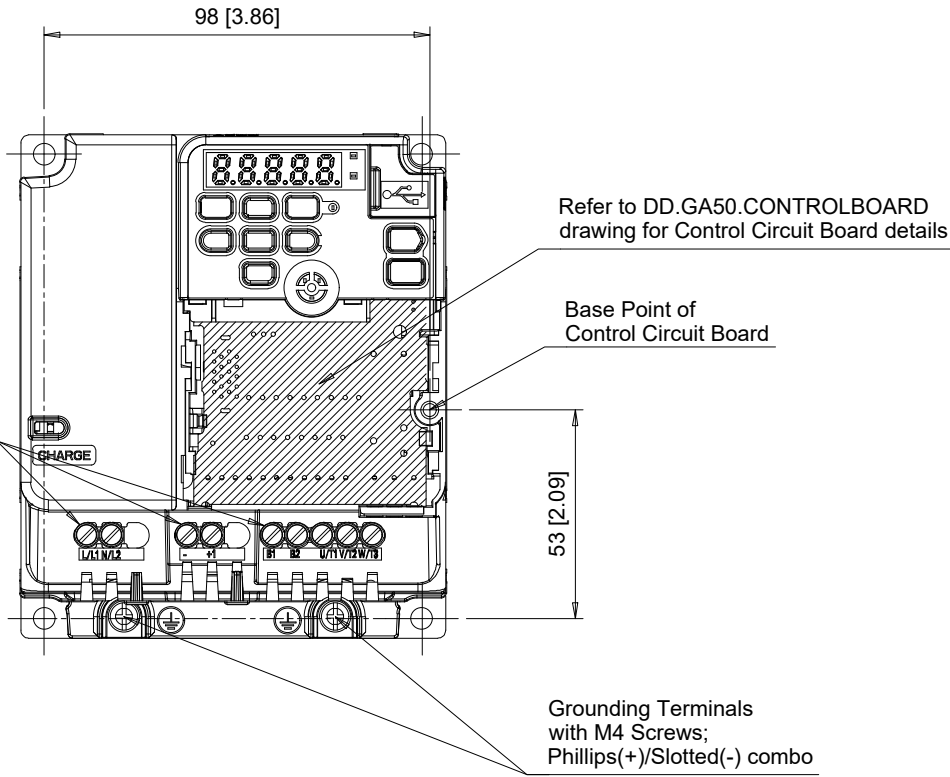

C/C:	TERMINAL SYMBOL	WIRE RANGE AWG (mm ²)	TERMINAL SCREW	CLAMPING TORQUE N.m. (lb.in.)
GA500□	L/L1, N/L2	14 - 10 (2.5 - 6)	M3	0.6 - 0.8 (5 - 7)
	U/T1, V/T2, W/T3	14 - 10 (2.5 - 6)	M3	0.6 - 0.8 (5 - 7)
B0100□□	- , +1	14 - 10 (2.5 - 6)	M3	0.6 - 0.8 (5 - 7)
	B1, B2	14 - 10 (2.5 - 6)	M3	0.6 - 0.8 (5 - 7)
	⊕	14 - 10 (2.5 - 6)	M4	1.2 - 1.5 (11 - 13)

□ Denotes A-Z

Note: Refer to applicable codes and standards for proper wire type and size.

YASKAWA

UNITS MM [IN]
SCALE 1:2

DRWN. J. MATTAS 7-20-21
CHKD. J. PIOTROWSKI 7-21-21
TECH. L. UDDIN 8-10-21
APRV. J. CAIRO 8-17-21

TITLE
GA500 DIMENSION DRAWING
FRAME SIZE 2.5
FINLESS HEATSINK

SIZE A
PAGE 2 OF 3
DWG.NO.
DD.GA50.FR2.5.FNL

REV
0

Minimum Installation Clearances

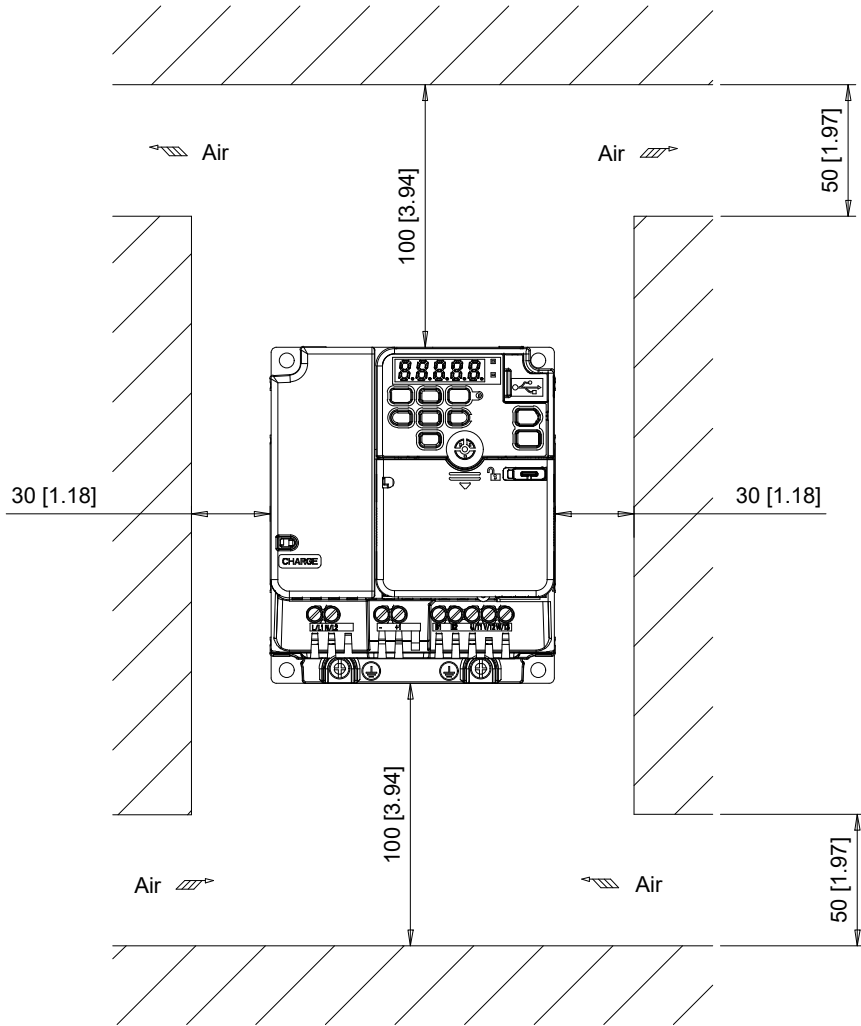

Note:
For alternate mounting configurations, consult manual.

Mounting Dimensions
Scale 1:2

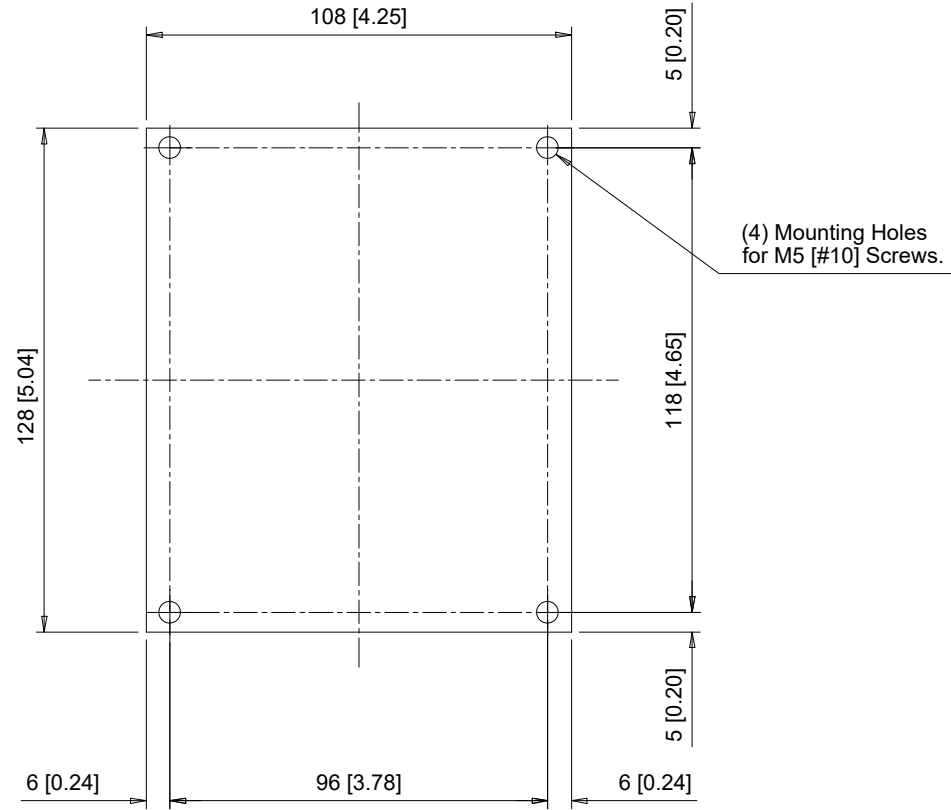

- Notes:
1. Mounting Plate Properties
 - Flatness shall not exceed 0.2mm
 - Roughness shall not exceed 25S
 - Temp. shall not exceed 90C (194F)
 2. Apply thermal compound between heatsink and mounting plate.
 3. Mounting Screw Torque
 - 2.0-2.5 Nm (17.7 - 22.1 lbf-in)
 4. See manual for complete details

YASKAWA

UNITS MM [IN]
SCALE 1:3

DRWN.	J. MATTAS	7-20-21
CHKD.	J. PIOTROWSKI	7-21-21
TECH.	L. UDDIN	8-10-21
APRV.	J. CAIRO	8-17-21

TITLE
GA500 DIMENSION DRAWING
FRAME SIZE 2.5
FINLESS HEATSINK

SIZE	A	PAGE	3 OF 3
DWG.NO.	DD.GA50.FR2.5.FNL		

REV
0